

CONSULTING ENGINEERS

MAXWELL ENGINEERS

Clients are our priority.

We endeavor to establish long term business relationships with our clients beyond the individual project or assignment.

It is our goal to have completely satisfied clients.

They are the foundation of our future.

**Where other engineers build projects,
Maxwell Engineers builds client relationships.**

RY 35967

EQUAL OPPORTUNITY/AFFIRMATIVE ACTION EMPLOYER

MAXWELL ENGINEERS

Main Office:

MAXWELL ENGINEERS, INC.

2555 Ponce De Leon Boulevard
Suite 220
Coral Gables, FL 33134

Business: 305-444-6260

Facsimile: 305-909-8111

Email: [**catkins@maxwellengineers.com**](mailto:catkins@maxwellengineers.com)

Website: [**www.maxwellengineers.com**](http://www.maxwellengineers.com)

CONSULTING ENGINEERS
MAXWELL ENGINEERS

Services

ANALYSIS / MODELING

ARCHITECTURAL DESIGN

BUILDING DESIGN & CODE COMPLIANCE

CONDOMINIUM TURNOVER REPORTS

CONSTRUCTION ADMINISTRATION & OBSERVATION

DEVELOPER AND DUE DILIGENCE INSPECTIONS

INSPECTION AND REPORTS

LITIGATION CONSULTING

REVIEW ANALYSIS RECOMMENDATIONS OF PROJECT SPECIFICATIONS

STRUCTURAL PEER REVIEWS

STRUCTURAL DESIGN & INVESTIGATION

REMEDIAL DESIGN

THRESHOLD INSPECTION

MAXWELL ENGINEERS

President

Toby A. Maxwell

Professional Engineers

Toby A. Maxwell
Angelica M. Agosta
Manuel Puma
Antonio J. Riva
S. Arturo Tablada

Threshold Inspectors

Angelica M. Agosta
Toby A. Maxwell
S. Arturo Tablada

Registered Architects

Craig J. Prandini
Pedro G. Suarez

Engineers in Training

Carlos Roman
Margarita Cadet

General Contractors

Toby A. Maxwell
Angelica M. Agosta
Craig J. Prandini
Felix D. Luque
James H. Bowen, III
Jacinto M. Torres

State Licenses

Alabama	New Jersey
Arizona	North Carolina
Arkansas	Ohio
Florida	South Carolina
Georgia	South Dakota
Kentucky	Tennessee
Louisiana	Texas
Maryland	U.S. Virgin Islands
Massachusetts	Vermont
Minnesota	Virginia
Mississippi	Washington, D.C.
Missouri	West Virginia

CONSULTING ENGINEERS
MAXWELL ENGINEERS

Atkins Engineers, Inc. was established in 1994 by Leonard C. “Lance” Atkins, P.E. to provide the highest quality engineering services to local, national and international clients. With over 55 years of experience, Lance Atkins is an industry leader. Lance’s knowledge and experience formed the philosophy that guided Atkins Engineers. His perseverance and technical skills were responsible for Atkins Engineers’ reputation as a preeminent, well-organized, and successful organization capable of understanding the individual needs of each and every client.

In 2022, Lance decided to reduce his workload and transition leadership responsibilities to Toby Maxwell. Toby joined Atkins Engineers in 2003 and worked in the field of civil/structural engineering for over a decade prior to joining the firm. As the Vice President of Atkins Engineers, Toby led day-to-day operations and project management beginning in 2020. He has firmly adopted the guiding philosophies of Atkins Engineers and continues the focus on developing long-term relationships with clients.

Maxwell Engineers has taken over where Atkins Engineers left off, with Toby assuming the role of President of the company. Although the company name has changed, all personnel, projects and our office location remain unchanged. Lance has remained involved to guide and consult.

The Firm’s main office is located in Coral Gables, Florida. Our other focused geographical locations are Miami, Amelia Island, Jacksonville, the Florida Keys and the Florida Panhandle. We cover jobs throughout the State, including Central Florida and Florida’s East and West Coasts.

The Firm specializes in consulting engineering services including: litigation support, structural peer reviews, construction inspections, threshold building inspections, structural design, construction management, and inspections such as: pre-purchase, construction, threshold building and conditional.

Maxwell Engineers never loses sight of the fact that while we practice the profession of engineering, we are at the same time running a business that provides our clients with quality and experienced service. With the diversity of our client base, new challenges and problems are always presenting themselves. Each client has unique needs and Maxwell Engineers is able to provide innovative engineering solutions to our client’s problems.

Maxwell Engineers is on the forefront of the ongoing changes occurring in the practice of engineering. We are flexible and responsive to any situation that presents itself. Maxwell Engineers pushes the envelope in finding creative and cost effective solutions to any engineering problem.

RELATIONSHIPS

The efforts of our company have always been concentrated on establishing a relationship with our clients while serving their needs. We do not follow the industry norm of seeking out and competing for individual projects, but rather look past the project to see the client and their goals.

Once you have benefited from our services, we believe you will be a client forever. Our list of clients whether they are a corporate entity, a real estate company, a developer or a law firm, tells the story.

AN ENGINEER'S PHILOSOPHY

Engineers are expected to be precise, definite, no-nonsense types, who are assigned a task and with little or no comment complete what they understand the project to be. Many times the client is not totally satisfied with the results of a completed project, often due to a lack of understanding or true listening on the part of the engineer. The philosophy of Maxwell Engineers sets us apart; we ***listen*** to our clients.

The practice of engineering is not what it used to be. Neither is Maxwell Engineers. We have grown along with our clients, both in size and scope of our practice. Our perspective of engineering is contemporary. We make engineering work for our clients by building our practice around that of our clients. We share our clients' goals and as they change, so do our solutions.

Our job is to listen and understand our clients' needs. Our experience and expertise give us the tools to anticipate the conditions and situations that may arise during our involvement with a client's project. We stand ready to analyze the alternatives that exist and to provide our clients with the information and expertise that is needed to provide both a quick and a permanent resolution to the situation at hand.

We fully realize when it comes to our individual client's requirements; one size does not fit all. Every client requires a customized service that fits precisely with their needs and interlocks exactly with their overall goals. Rather than make our client fit our policies and procedures, we adjust to fit you.

After an assignment is given to this firm, there are often revised parameters that necessitate changes, making the first choices of direction or initial selections no longer adequate. Our firm has the management skills to make the necessary adjustments in direction quickly and efficiently to arrive at the client's goal.

We assemble a team of qualified professionals to complete the mission and we can easily change or augment the group to meet any revised target by the client. Our work is tailored to our clients and their needs.

We inspect existing properties for highest and best use, economic viability, useful life, space utilization, required accelerated maintenance and conformance with engineering and construction standards. These services are typically provided to the banking, development and real estate industries. These services are also supplemented with conversion reports, if required by the client.

We perform peer review, in order to isolate potential troubling areas of design, and follow-up the work during construction, so as to minimize potential liability for the builder and/or developer. We help in close-out procedures to alleviate problems often encountered during turnover.

We provide estimated costs and scheduling to complete or revise projects that for one reason or another have become troubled or gone off-track.

We evaluate property for potential development of hotels and resorts, high-rise residential, industrial or commercial use. Buildings are inspected for future performance, acceptability with the construction industry standards and compliance with local and national Building Codes.

We provide our clients with our expertise in construction litigation. The services we deliver typically involve construction management, cost estimating, or design analysis. Our primary goal in this area of service is to provide our clients with a solid understanding of the physical parameters of the situation and their financial impact. This information allows them to make the right decisions at the right time.

Engineering today at Maxwell Engineers, Inc. entails much more than the design or construction of any one project. It is the evolution of our philosophy that the “***Client is First***” that keeps us in the industry’s forefront. Thanks to our clients and their goals, we remain separate and apart from the crowd.

Maxwell Engineers will help you accomplish your goals.

TOBY A. MAXWELL, PE, SI, CGC, MBA
PRESIDENT

Toby Maxwell, the principal consulting engineer of the company, received his Bachelor of Civil Engineering degree from University of Alabama and his Master of Business Administration degree from Webster University. Toby joined Atkins Engineers in 2003 and was involved in the field of civil/structural engineering for over ten years prior to joining the firm. Toby led day-to-day operations and project management of Atkins Engineers for several years prior to taking over leadership responsibilities for the firm as President of Maxwell Engineers in 2022. Toby continues the focus on developing long-term relationships with our clients.

Registration: Professional Engineer since 2001

Alabama	Louisiana	New Jersey	Texas
Arizona	Maryland	North Carolina	Vermont
Arkansas	Massachusetts	Ohio	Virginia
Florida	Minnesota	South Carolina	U.S. Virgin Islands
Georgia	Mississippi	South Dakota	Washington D.C.
Kentucky	Missouri	Tennessee	West Virginia

Certified General Contractor - State of Florida 2007
Threshold Building Inspector - State of Florida 2001

Professional Affiliations:

American Architectural Manufacturers Association
American Concrete Institute
American Institute of Steel Construction
American Society of Civil Engineers
American Society for Testing and Materials
ASTM Committee E58 on Forensic Engineering
Council of American Structural Engineers
Engineers Without Borders
Florida Engineering Society
Florida Structural Engineers Association
Institution of Engineers Ireland
International Concrete Repair Institute
National Council of Structural Engineers Associations
National Society of Professional Engineers
The United States Council For International Engineering Practice

LAW FIRM CLIENTS

Adams and Reese, LLP	Kubicki Draper
Akerman	Lapin & Leichtling
Bachara Construction Law Group	McGuireWoods
Baker McKenzie	Mitrani, Rynor, Adamsky & Toland
Ball Janik	Pardo Jackson Gainsburg
Baumann, Gant & Keeley	Peckar & Abramson
Becker & Poliakoff	Quintairos, Prieto, Wood & Boyer
Bressler, Amery & Ross	Rennert Vogel Mandler & Rodriguez
Carlton Fields	Robinson & Cole
Carr Allison	Rogers Towers
Cole, Scott & Kissane	Saul Ewing Arnstein & Lehr
Conroy Simberg	Shutts & Bowen
Derrevere Stevens Black & Cozad	Siegfried Rivera
Foley & Lardner	Southeast Law Group
Fowler White Burnett	Taylor Espino Vega
Goldberg Segalla	The Law Office of Stuart R. Michelson
Greenberg Traurig	The Rock Law Group
Haber Law	Vernis & Bowling
Hicks Porter Ebenfeld & Stein	Wade, Palmer & Shoemaker
Hill Ward Henderson	Welbaum Guernsey
Holland & Knight	Wicker Smith
Katz Barron	Zelle

DEVELOPER REAL ESTATE CLIENTS

13th Floor Investments
Avatar Development Corporation
Berkowitz Development Group
Centerline Homes
Century Village
Continental Real Estate Company
Crescent Heights
Cushman & Wakefield of Florida
Groupe Pacific
KB Homes
Lennar Corporation
Nobel House Hotels & Resorts
NVR-Ryan Homes
Panterra Development LTD
Plaza Property Group
South Beach Partners
Southcoast Partners
The Astor Companies
The Related Group of Florida
The St. Joe Company

PROPERTY MANAGEMENT CLIENTS

Amelia Island Management
Atlantic Pacific Management
Castle Group, LLC
CSI Management Services
First Residential Services, Inc.
KW Property Management, LLC
Miami Management, Inc.
Sentry Management, Inc.
Skyline Management, Inc.

GENERAL CONTRACTOR CLIENTS

Beauchamp Construction, Inc.
Bovis Lend Lease, Inc.
Complete Property Services, Inc.
CDC Builders, Inc.
Lennar Homes, LLC
National Concrete & Construction, LLC
Pavarini Construction Company, Inc.
Pro-Max Restoration and Paint Corporation
Suffolk Construction
Structure Tone
The Haskell Company
Tutor Perini Corporation

CONDOMINIUM CLIENTS

350 Las Olas
900 Biscayne
Almeria Park
Artepark
Bellini Williams Island
Bella Vista North & South
Bellini Condominium
Caribbean Resort
City24
Cityplace South Tower
Deering Bay – Club Villas, Milano, Padua, Siena & Verona
Gables Club
Grand Bay Residences & Towers
Grove at Grand Bay
Hamptons South
Jade East
Jade Ocean
Jade Residences
Latitude On The River
Le Club International
Long Beach Resort
MEI
Oceania IV
Portofino Tower
Sands Pointe Ocean Beach
Santa Maria
South Tower at Porto Vita
Spiaggia Ocean
The Club at Brickell Bay
The Gables
The Mark on Brickell
Turnberry on The Green
Wind
Yacht Club at Portofino

Turnover Projects

INSPECTIONS

Inspection services and reports are provided to the construction industry, real estate investors, developers, and management companies. The level of inspection is designed to fit each individual situation and may include a review of the structure; the building envelope including roofing, windows, walls, and waterproofing; and an overview of the mechanical and electrical systems. Threshold Structural Inspections are made and reports issued for construction industry clients. Reports on due diligence inspections are provided to real estate industry clients.



Jade Residences at Brickell Bay
1331 Brickell Bay Drive
Miami, Florida 33131



The Club At Brickell Bay
1200 Brickell Bay Drive
Miami, Florida 33131



Wind Condominium
350 South Miami Avenue
Miami, Florida 33130



MEI Condominium
5875 Collins Avenue
Miami Beach, Florida 33140

Turnover Projects



Grand Bay Residences
430 Grand Bay Drive
Key Biscayne, Florida 33149



Grove at Grand Bay Condominium
2669 South Bayshore Drive
Coconut Grove, Florida 33133



One Ocean Condominium
One Collins Avenue
Miami Beach, Florida 33139



Calypso Tower Resort
15817 Front Beach Road
Panama City Beach, Florida 32413



Sterling Breeze Condominium
16701 Front Beach Road
Panama City, Florida 32413



Sterling Beach Condominium
6627 Thomas Drive
Panama City Beach, Florida 32408

Turnover Projects



Bellini Condominium
*10225 Collins Avenue
Bal Harbour, Florida 33154*



Turnberry On The Green
*19501 West Country Club Drive
Aventura, Florida 33180*



Hamptons South Condominium
*20201 East Country Club Drive
Aventura, Florida 33180*



350 Las Olas Place Condominium
*350 Southeast 2nd Street
Ft. Lauderdale, Florida 33301*



Almeria Park Condominium
*337 Almeria Avenue
Coral Gables, Florida 33134*



LeJeune Plaza Condominium
*215 Southwest 42nd Avenue
Coral Gables, Florida 33134*

Turnover Projects



The Plaza Condominium
*400 East Bay Street
Jacksonville, Florida 32202*



The Residences of Winter Park
*300 South Interlachen Avenue
Winter Park, Florida 32789*



Sides Moreno Point West
*5 Calhoun Avenue
Destin, Florida 32541*



The Collins Condominium
*6917 Collins Avenue
Miami Beach, Florida 33141*



ParkCrest Harbour Island
*700 South Harbour Island Boulevard
Tampa, Florida 33602*



Sterling Reef Condominium
*12011 Front Beach Road
Panama City Beach, Florida 32407*

Construction and Observation Administration Projects

These projects consist of repairs to exterior and interior of construction. Management consisting of review of construction activities and due diligence construction review.



Carlton Dunes Condominium
4658 Carlton Dunes Drive
Amelia Island, Florida 33034



Jade Ocean Condominium
17121 Collins Avenue
Sunny Isles, Florida 33160



Dunes Club Condominium
1700 Dunes Club Place
Amelia Island Plantation, Florida 32034



Majestic Sun Condominium
112 Seascape Drive
Destin, Florida 32550



The Plaza Condominium
400 East Bay Street
Jacksonville, Florida 32202



Fisher Island Condominium
One Fisher Island Drive
Fisher Island, Florida 33109

Concrete & Post-Tension Repair/Restoration and Painting

Inspections of concrete & post-tension repair/restoration and painting projects are provided to condominium clients and management companies. To obtain a permit for a concrete or post-tension restoration project on a threshold building, the FBC requires that structural inspections be performed by a Special Inspector for Threshold Buildings. In the State of Florida, less than 2% of registered Professional Engineers are certified as Special Inspectors. Three of our licensed Professional Engineers are also certified as Special Inspectors of Threshold Buildings.



900 Biscayne Bay Condominium
900 Biscayne Boulevard
Miami, Florida 33132



Almeria Park Condominium
337 Almeria Avenue
Coral Gables, Florida 33134



City 24 Condominium
350 NE 24th Street
Miami, Florida 33137



Harbour House Condominium
Barracuda Lane
Key Largo, FL 33037

Concrete & Post-Tension Repair/Restoration and Painting



Island Breakers Condominium
150 Ocean Lane Drive
Key Biscayne, FL 33149



Jade Residences at Brickell Bay
1331 Brickell Bay Drive
Miami, Florida 33131



Latitude on the River Condominium
185 SW 7th Street
Miami, FL 33130



Trump Towers Condominium
15811 Collins Avenue
Sunny Isles Beach, Florida 33160

Structural Peer Reviews Projects

Services consists of identifying potential construction or design flaws. Review of drawings, specifications and conformance with applicable local building codes and industry standards.



Eloquent On The Bay
7928 East Drive
North Bay Village, Florida 33141



Turnberry Tower Condominium
19355 Turnberry Way
Aventura, Florida 33180



Trump Towers Condominium
15811 Collins Avenue
Sunny Isles Beach, Florida 33160



Venture at Aventura East
18800 Northeast 29th Avenue
Aventura, Florida 33180



Loft Downtown I
234 Third Street
Miami, Florida 33132



Long Beach Resort
10513 Front Beach Road
Panama City Beach, Florida 32407

Litigation Consulting

Expert testimony and investigation reports are provided to the attorneys and their clients based on construction inspection and analysis, design review, building code interpretation and other studies required by the unique circumstances of each specific client matter.



Asia Brickell Key Condominium
900 Brickell Key Boulevard
Miami, Florida 33131



Merrick Manor Condominium
301 Altara Avenue
Coral Gables, Florida 33146



Jade Beach Condominium
17001 Collins Avenue
Sunny Isles Beach, Florida 33160



Acqualina Resort & Spa on the Beach
17875 Collins Avenue
Sunny Isles Beach, Florida 33160

Litigation Consulting



ArtePark North Condominium
2155 Washington Court
Miami Beach, Florida 33139



Midtown Doral Condominium
7761 NW 107th Avenue
Doral, Florida 33178

New Building Design and Threshold Inspection

Structural and Civil engineering design services are provided for construction industry clients. This includes design and analysis for structural restoration and new projects.



The Palms 2 - Condominium
2110 Ocean Boulevard
Fort Lauderdale, Florida 33305



Oakland Park
1001 NE 58th Street
Oakland Park, FL 33334

Analysis and Modeling

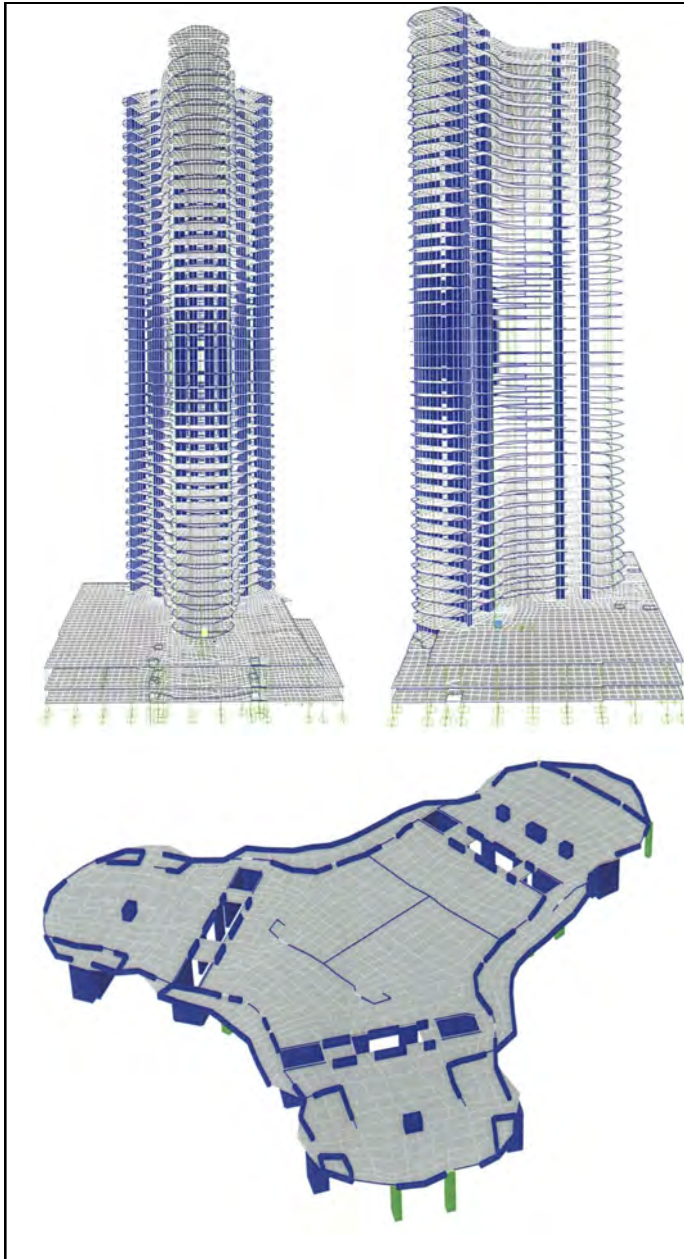

Finite Element Analysis and Modeling

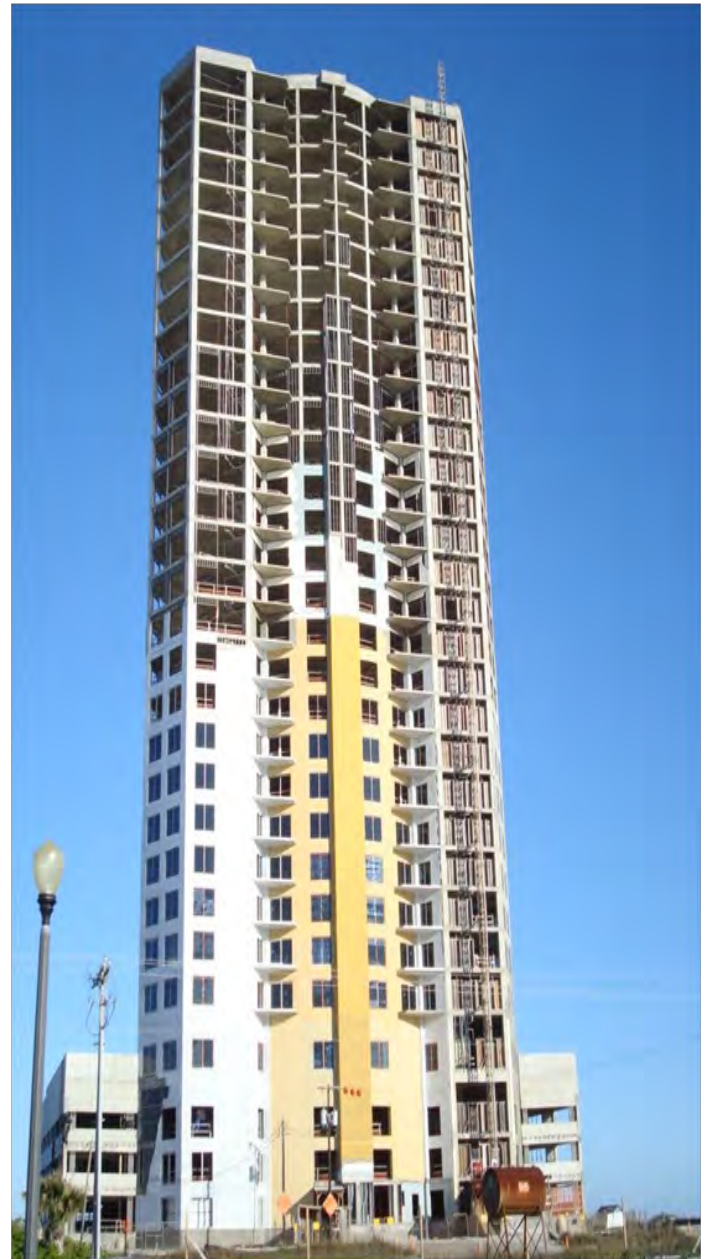

Ocean Tower
28471 South Park Road 100
South Padre Island, Texas 78597